

KST
VALVE

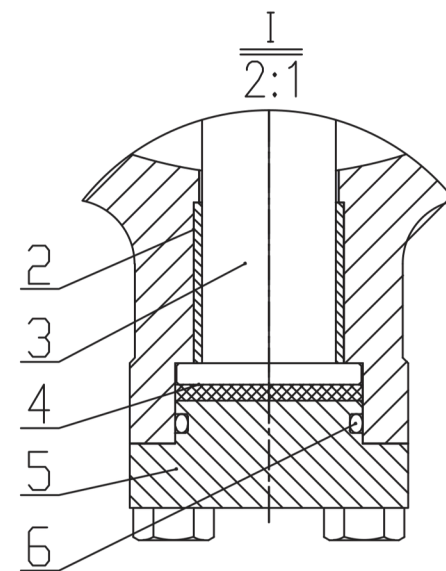
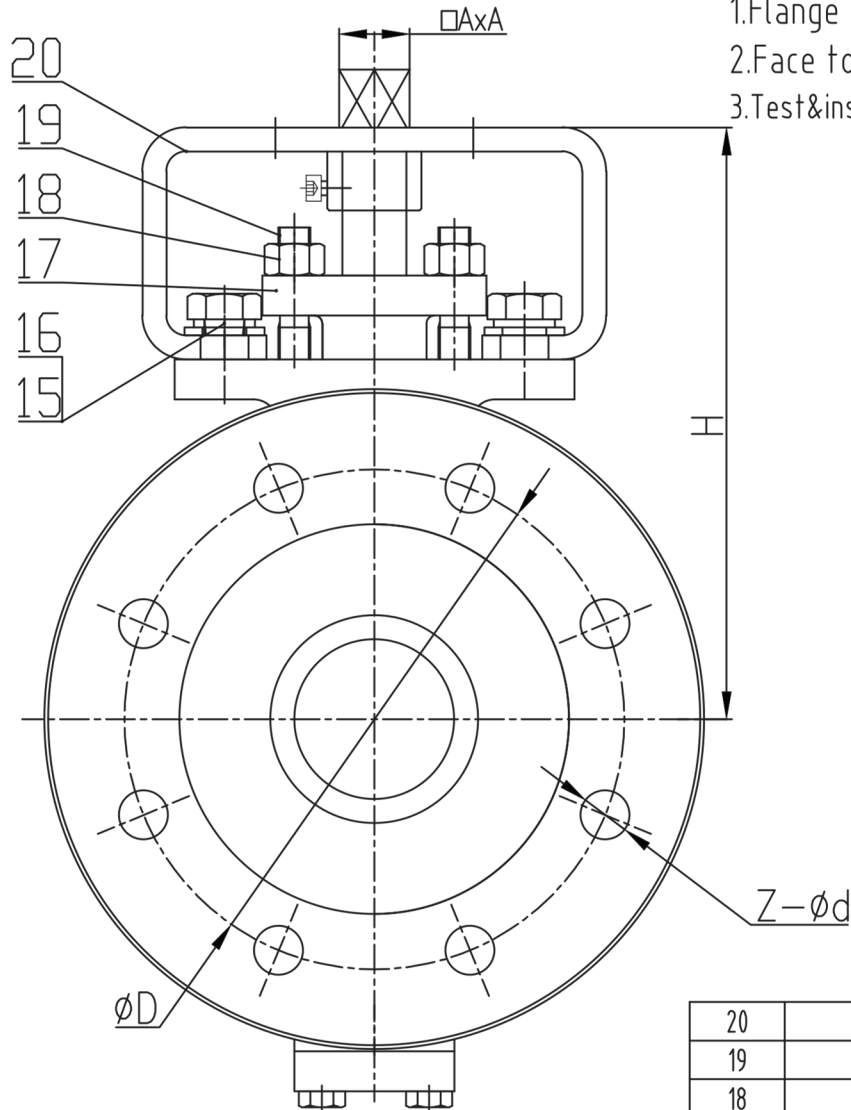
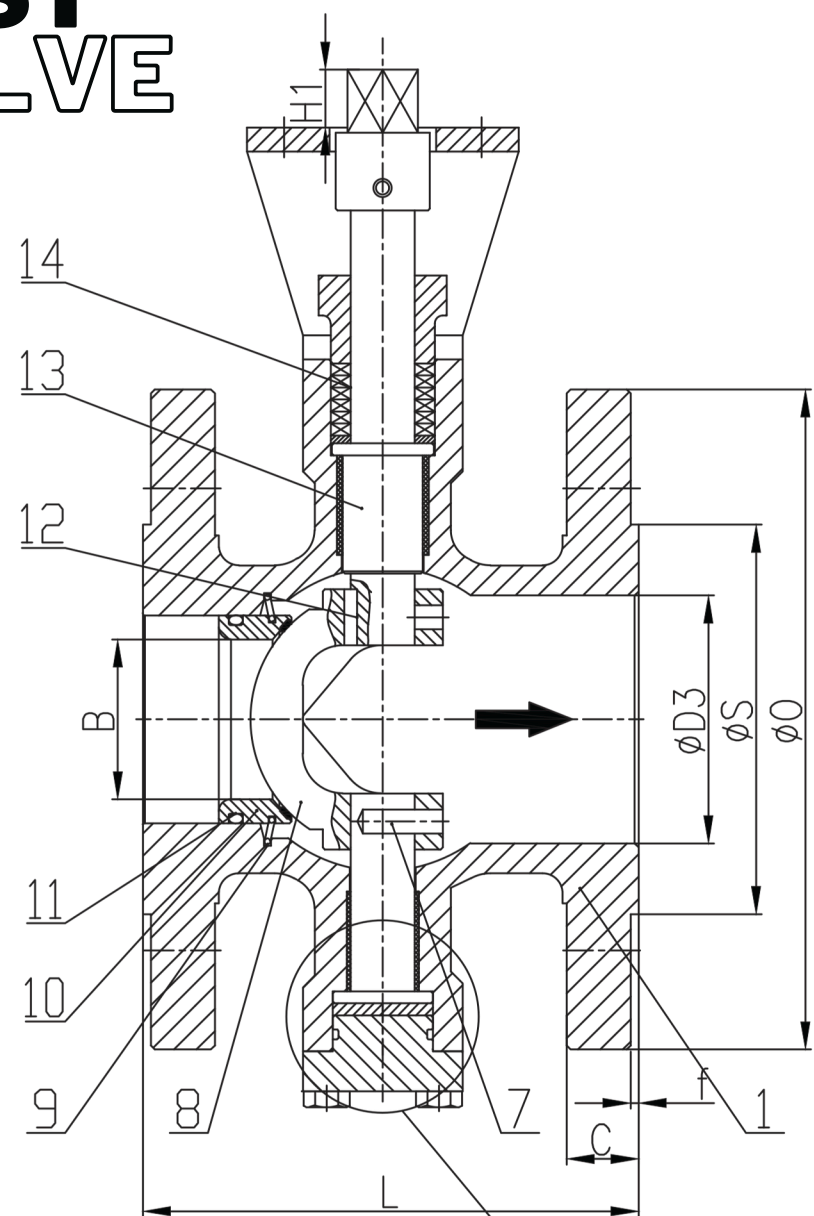

Standard compliance
1.Flange connection:ASME B16.5
2.Face to face:ISA S 75.04-1995.
3.Test&inspection:ISO5208 RateD×10 hydrostatic test

Performance Specification			
CLASS		150	
Test	Shell	3.0	Mpa
	Back Seal	/	
	Seal	2.2	
Working temperature		-29~120℃	
Suitable Medium		Water Gas Oil	

NPS	L	B	O	D	S	D3	C	f	Z-φd	H	H1	AxA	D1	D2	n-φd1	n-φd2	ISO 5211
1	102	20	110	79.4	50.8	38	11.6	2	4-φ16	131	18	14×14	70	50	4-9	4-7	F05×F07
1¼	102	25	115	88.9	63.5	45	13.2	2	4-φ16	141	18	14×14	70	50	4-9	4-7	F05×F07
1½	114	32	125	98.4	73	50	14.7	2	4-φ16	138	18	14×14	70	50	4-9	4-7	F05×F07
2	124	40	150	120.7	92.1	62	16.3	2	4-φ18	148	18	14×14	70	50	4-9	4-7	F05×F07
2½	145	55	180	139.7	104.8	77	17.9	2	4-φ18	163	18	14×14	70	50	4-9	4-7	F05×F07
3	165	65	190	152.4	127	93	19.5	2	4-φ18	205	25.5	17×17	102	70	4-12	4-9	F07XF10
4	194	80	230	190.5	157.2	115	24.3	2	8-φ18	215	25.5	17×17	102	70	4-12	4-9	F07XF10
5	194	100	255	215.9	185.7	134	24.3	2	8-φ22	230	25	22×22	102	70	4-12	4-9	F07XF10
6	229	126	280	241.3	215.9	164	25.9	2	8-φ22	270	30	27×27	125	102	4-14	4-12	F10XF12
8	243	158	345	298.5	269.9	206	29	2	8-φ22	302	30	27×27	125	102	4-14	4-12	F10XF12
10	297	198	405	362	323.8	260	30.6	2	12-φ26	365	40	27×27	140	125	4-18	4-14	F12XF14
12	338	250	485	431.8	381	316	32.2	2	12-φ26	410	40	27×27	165	140	4-22	4-18	F14XF16
14	400	282	535	476.3	412.8	350	35.4	2	12-φ30	443	40	36×36	165	140	4-22	4-18	F14XF16
16	400	316	595	539.8	469.9	405	37	2	16-φ30	478	48	46×46	200	160	8-18	4-22	F16XF20

NO.	Part Name	Material	Material	Material
20	Yoke	ASTM A316	ASTM A316	ASTM A3
19	Nut			ASTM A194 8M
18	Stud			ASTM A193 B8M
17	Packing Gland			ASTM A351 CF8M
16	Washer			SS316
15	Bolt			ASTM A193 B8M
14	Packing			PTFE
13	Stem			17-4PH
12	Key			SS316
11	O-ring			FKM
10	Seat			ASTM A182 F316+STL
9	Spring			17-7PH
8	Ball			ASTM A351 CF8M+Cr
7	Pin			SS316
6	O-ring			FKM
5	Cover			ASTM A351 CF8M
4	Gasket			PTFE
3	Shaft			SS316
2	Bushing			SS316+PTFE
1	Body			ASTM A351 CF8M

Rev.2#

2018.3

MANUFACTURER:
TYPE: Segment Ball Valve
MODEL: NPS1"-16" GUV147Y-150LB